

D.O. suggestions - Mr. Patterson's visit May 27-29 1946

A most constructive suggestion was made by Mr. Patterson with regard to the treatment of the herbaceous border and its surroundings. As a result of their agreement the two consultants therefore suggest that instead of building walls on either side of the herbaceous border as had been previously suggested, that a heavy border of deciduous and evergreen shrubs be planted on either side of the border in order to replace the two Yew hedges which are difficult to maintain and which will become increasingly unsightly as they become more aged. Instead of a long wall down the steep slope this border of shrubs will give an informal line to the border and will moreover narrow the space quite considerably for the planting of herbaceous and annual plants. This should decrease the cost of upkeep materially. Around the two Yews at the top and bottom of the walk low stone walls might be constructed of approximately the height of the Yew hedges and low stone walls across the east end of the upper kitchen garden. The construction of these low walls and the replacement of the hedge on the sloping ground will allow the elimination of all the Yew hedges by either permanent and easily replaceable plantations or low stone walls. *Keep some yew hedge*

The planting on either side of the herbaceous border could well be made harmonious with both the orchard on the south side and the stone walls on the north side of the steps.

Y/NK North Vista

The temporary wooden rail fence should be much more thoroughly covered with evergreen creepers such as honeysuckle or ivy, so that the rail fence would disappear and become more like a section of the wall. The re-planting and re-studying of the planting in the north vista seems a necessity as clearly the two Yew clumps on either side of the north entrance do not look well. These should be removed, possibly two big Box clumps from the rose garden might be placed in the northeast and northwest corners.

As the azaleas in the Star are magnificent as plants but overgrown as accents to this space, it is suggested that the largest of these plants be taken out and used on the bank north of the swimming pool and that the overgrown plants be replaced by smaller ones of the same sort.

*possibly scatter around W N & E side
Tennis exterior wall adjoining*

D.O. Suggestion page 3 May 27-29-1946

At Dumbarton, as in most other places, one of the serious problems concerns the parking of motor cars. The space in front of the south door is clearly inadequate for crowds and as chauffeur-driven cars are the exception rather than the rule in these days it would seem necessary to find a parking space more or less adjacent to the grounds and to keep the small parking area in front of the front door for cars of invalids.

From Mr. Patterson's report it is also quite clear that creepers have been allowed to grow to undue size and that they hide the views which used to be attractive from the box terrace to the rose garden and that they over-encumber the walls and steps leading from the box terrace to the rose garden. It might even be wise to clear a space where a view of the rose garden could conveniently be seen from both the south and the north borders in the box terrace, and to restrain the creepers in their uncurbed enthusiasm.

On Mr. Patterson's next journey many of these details will be discussed and further studies made of individual areas and consultations as to the walk widenings seem also desirable.

*Crab Hill - take off heavy branches
near path before placing against
Mr. Stair*

*{ Consoles N. Vista
{ finials*

*removing 2 big box wood for
Rose Garden very expensive &
N. Gate ones are clumps*

*Remove 4 ailing haystack box for Cornish
beds & plant roses
Box Wood overgrown could be sold at present*



General Leach House 8 April - birds
round stone retaining wall -

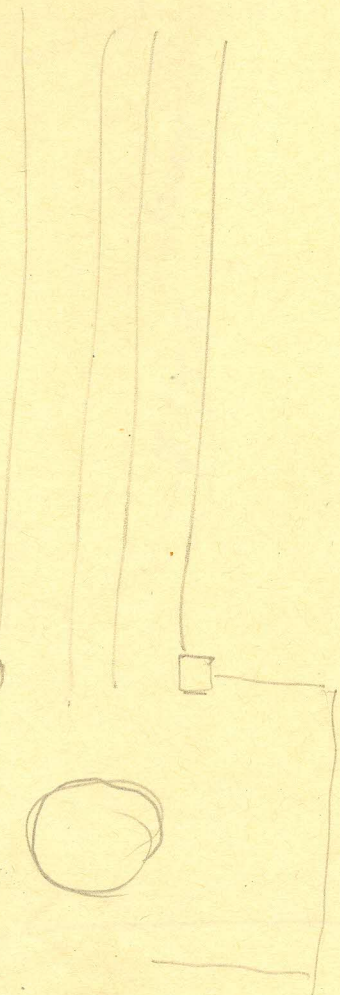

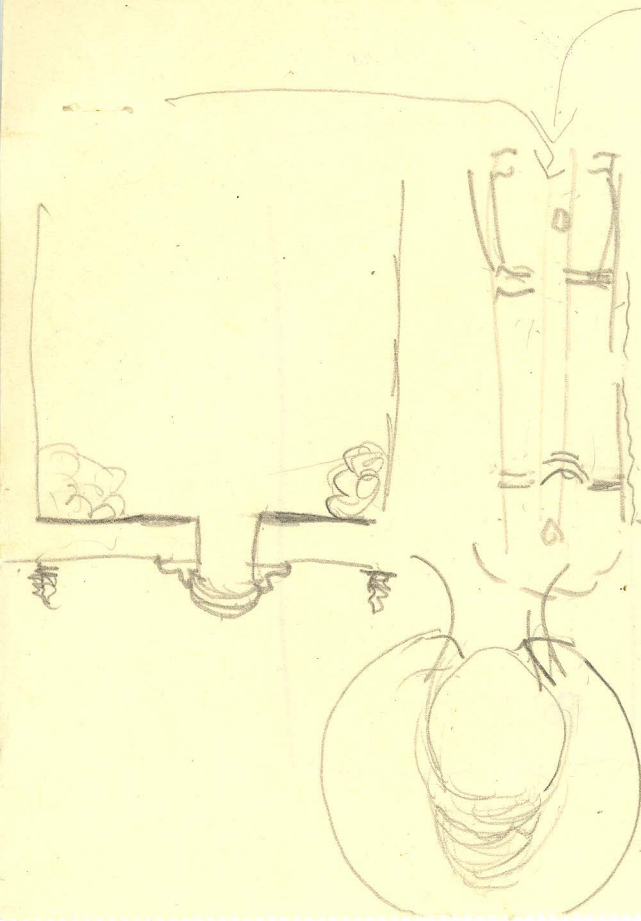

Star Garden - why they with agaveas?
Cock Hill - dwarfed variety

